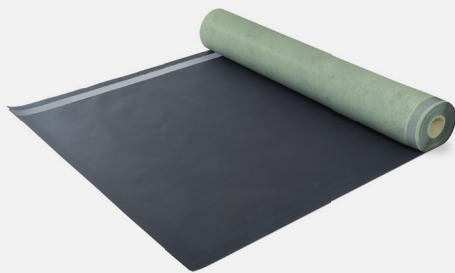

## PRODUCT DATA SHEET

**OMEGA G20 Facade Lining**

Highly vapour-permeable, UV-stabilized facade lining with two integrated acrylate glue strips for wood facades with back ventilation. The special coating permits use on facade constructions with shadow gaps of up to 20 mm.

**FIELD OF APPLICATION**

- For wood facades with up to 20 mm wide joints

**ADVANTAGES**

- Rain-tight
- Wind-tight
- UV-stabilized
- Extremely diffusive
- Easy to cut
- Anti-glare



**RECOMMENDED PRODUCTS**

-  OMEGA N55 Adhesive
-  OMEGA UVKB Facade Tape
-  FASCON EPDM Tape
-  OMEGA FA GD2 Pipe Sleeve
-  AIRSTOP FROZEN Adhesive Paste

**AVAILABLE IN THE FOLLOWING DIMENSIONS**

Type	Standard	Standard	SK DUO
Roll width	1,5 m	3 m	1,5 m
Roll length	50 m	50 m	50 m
Roll area	75 m <sup>2</sup>	150 m <sup>2</sup>	75 m <sup>2</sup>

**PRODUCT DATA (EN 13859-2)**

Material composition	PES fleece with TPU coating on one side, two acrylic adhesive strips on both front and back edge	
Thickness	0,25 mm	
Colour	Black	
Weight	185 g/m <sup>2</sup>	
sd-value	0,18 ± 0,03 m	
Temperature resistance	-30 °C - 80 °C	
UV-resistance	Durable	
Resistance to water flow EN 1928	W1	
Expandability EN 12311-1	 20 % (±5)	 25 % (±5)
Tensile strength EN 12311-1	 350 N/50 mm	 300 N/50 mm
Tear propagation resistance EN 12310-1	 100 N	 120 N
Long-term behaviour	Permanent long-life under facades with up to 20 mm wide joints	
UV-resistance uncovered	12 months	
Fire performance EN 13501_1 / EN 11925_2	B-s1, d0	

# OMEGA G20 Facade Lining

## TIPS FOR PLANNING

The surface must be dry and clean, and there should be no sharp corners. The size of the wooden or metal substructure should be adjusted to match the width of OMEGA Facade Lining. Calculations should take into consideration overlaps of a minimum of 10cm.

For mounting of OMEGA Facade Lining (mechanically or by adhesion) the bearing surface for attachment of the lining must be a minimum of 5cm. The adhesive functions as a seal and does not take the place of a strong bond. OMEGA Facade lining must subsequently be fixed mechanically. Battens / back ventilation must be provided between the lining and the visible wooden cladding!

### (1) ROLL MEASUREMENT

Standard rolls can be cut to length using a circular saw / band saw. The cut edges must always overlap.

### (2) STORAGE

OMEGA Facade Lining should be stored in a horizontal position and handled with clean hands and tools. Pay attention that OMEGA Facade Lining is not folded or bent.

### (3) & (4) LAYING

Unroll OMEGA Facade Lining vertically from top to bottom (or horizontally from left to right). First position straight on one side and fix temporarily, then pull to the other three sides and guarantee that the OMEGA Facade Lining is tightly laid. Attach OMEGA Facade Lining to the supporting construction mechanically using tacker clips or similar. Secure all loose overlaps, corners and edges.

### (5) ADHESIVE TECHNIQUE

Wind-tight adhesion at connections and overlaps of lengths of OMEGA Facade Lining are achieved using AIRSTOP FROZEN, OMEGA N55 Adhesive or OMEGA UVKB Facade Tape (Vertical joint bonding). When using SK DUO, adhesion at overlaps is made using the acrylate adhesive strips attached. Shake the adhesive well in the container and pour into the plastic bottle provided. Apply the adhesive in the area of the facade lining overlap, spread with a paintbrush and finally press on using a dispenser or clean cloth. Caution: do not let the adhesive flash off (so-called wet-in-wet adhesion).

### (6) CONNECTIONS

Use AIRSTOP FROZEN for connection to masonry or metal. Materials used must be free from dust and grease and the substructure must be dry and supporting. Always pre-treat connections on very absorbent substrates with Primer. Press OMEGA Facade Lining well into the applied sealant. Connection with metal, concrete, plastic and wood can also be carried out using OMEGA N55 Adhesive. Spread the OMEGA N55 on the substrate using a paintbrush, allow to flash-off and then bond wet-in-wet with an additional layer of OMEGA N55 and press the OMEGA Facade Lining on well. (Depending on the substrate adhesion of connections with OMEGA N55 can also be carried out in one process with wet-in-wet adhesion. As a rule we recommend an adhesion test.

### (7) WINDOW CONNECTIONS

OMEGA Facade Lining can be fixed to a wooden, PVC or metal window frame using AIRSTOP FROZEN, OMEGA N55 or OMEGA OMEGA UVKB facade tape. Application as above, see 'CONNECTIONS'.

## RESTORATION

Damaged spots can be glued wet-in-wet with a segment of Facade Lining and using OMEGA N55 Adhesive.

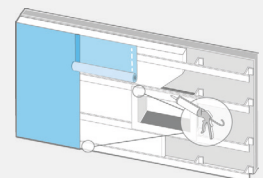
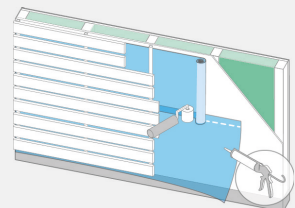
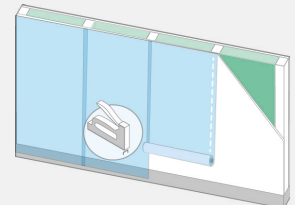
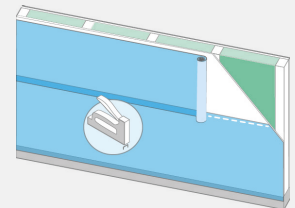
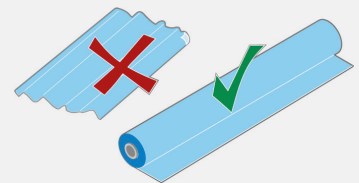
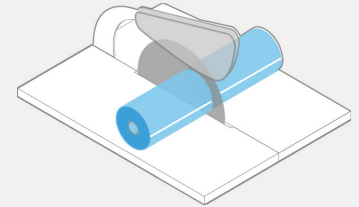

#### ISOCELL GmbH & Co KG

Gewerbestraße 9  
5202 NEUMARKT AM WALLERSEE | Österreich  
Tel.: +43 6216 4108  
office@isocell.at

#### ISOCELL SCHWEIZ AG

Herbergstrasse 29  
9524 ZUZWIL | Suisse /Schweiz  
Tel.: +41 71 940 06 72  
office@isocell.ch

#### ISOCELL FRANCE

170 Rue Jean Monnet | ZAC de Prat Pip Sud  
29490 GUIPAVAS | France  
Tél.: +33 2 98 42 11 00  
contact@isocell-france.fr

#### ISOCELL BUREEL BELGIË

Außenborner Weg 1 | Schoppen  
4770 AMEL | Belgique  
Tel.: +32 80 39 90 58  
office@isocell.be

#### ISOCELL Sverige AB

Torshamnsgatan 35  
164 40 KISTA | Sverige  
Tel.: +46 10 130 25 00  
info@isocell.se

**ISOCELL**  
www.isocell.com